

Ecoflam

DUAL FUEL RANGE

MULTIFLAM



www.ecoflam-burners.com

CUSTOMIZED BURNERS SOLUTIONS FOR ANY TYPE OF APPLICATION



OUR EXPERIENCE

Thanks to almost 50 years of experience in the design and production of burners, Ecoflam offers a full range of blown air pressure jet burners covering an extremely wide range of power, from small products for residential heating applications to high power burners dedicated to the industrial segment.

Ecoflam burners are renowned worldwide for providing high efficiency and reliable operation with significant energy savings and feature extreme ease of installation, maintenance and flexible boiler-burner matching.

OUR MISSION

Following a philosophy of continuous improving, the R&D Laboratory is constantly working to produce better results, such as the reduced NOx level emissions.

The development of new advanced combustion technologies allows to propose solutions in respect of the most stringent environmental regulations and to create the perfect condition to face the new upcoming market requests, such as Ultra Low NOx performance and ErP-ready products.



OUR PRODUCT RANGE

The flexibility of Ecoflam solutions allows the manufacturing of highly customized products covering a range from 17 kW to 34 MW:



MAX GAS

Gas range
17 - 700 kW



BLU

Gas range
245 - 17000 kW



MAX

Light oil range
18 - 546 kW



MAIOR

Light oil range
300 - 17000 kW

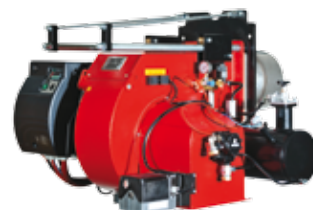

MAXFLAM/OILFLAM

Heavy oil range
68 - 17000 kW



OUR PROFESSIONAL TEAM

Ability to design state-of-the-art burners, manage demands of products for specific applications, ability to solve problems in real time are just some of the characteristics of our technicians and engineers.

But not only: Ecoflam has a worldwide network of service technicians able to support the installation, the commissioning and the periodic maintenance activities of the burner.

OUR INTERNATIONAL APPROACH

Our products are designed, developed and manufactured in Italy, combining quality, reliability and high performance. All these features are necessary for the end-user satisfaction, which is the first target for Ecoflam. Reaching this outcome throughout its extensive worldwide network of distributors and customers has always been a challenging task for Ecoflam, which was achieved only by developing a close and personalized relationship with each customer, always taking into account the needs and the distinctive characteristics of each individual market.



MULTICALOR

Dual fuel (gas/light oil)
190 - 17000 kW

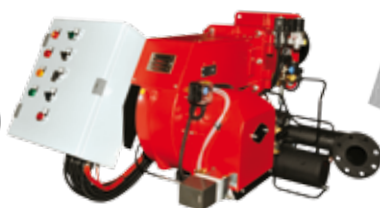

MULTIFLAM

Dual fuel (gas/heavy oil)
414 - 17000 kW



TS RANGE

All fuels
230 - 34000 kW

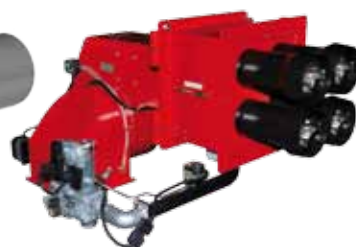

SPECIAL VERSIONS

DUAL FUEL (GAS/HEAVY OIL) | MULTIFLAM

RANGE OVERVIEW

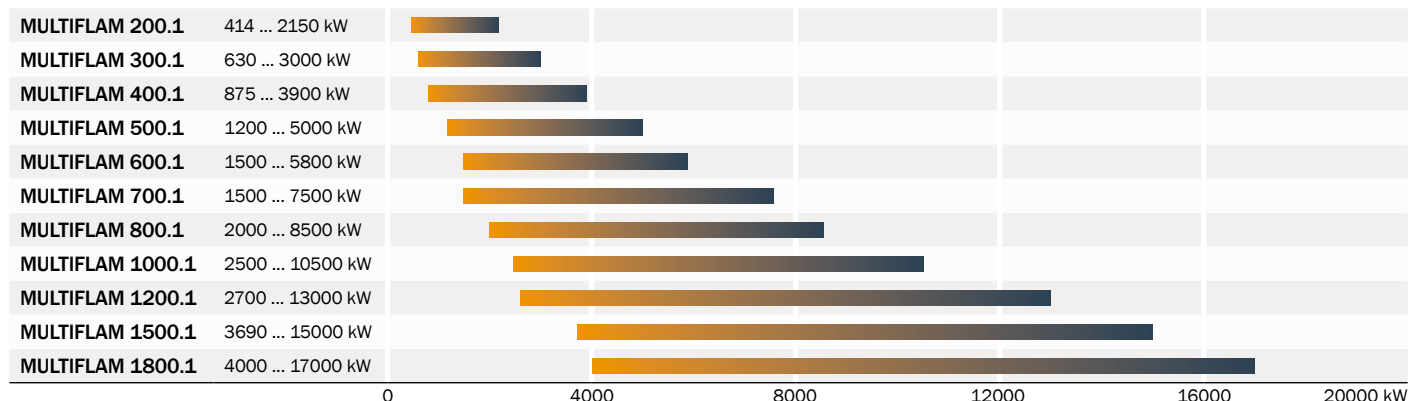

MAIN FEATURES

- Two stage version with electric servomotor and integrated system for the regulation of air and fuel (for MULTIFLAM 200.1)
- Progressive version with electric servomotor and double adjustable mechanical cam that allows air and fuel fine tuning
- Modulating version with PID system controller with digital set point display and real time value
- Version with fully electronic Burner Management System available for all models
- Digital thermoregulator integrated on the front panel to grant temperature stability of the fuel (from MULTIFLAM 300.1)
- Adjustable combustion head for easy regulation and matching with different combustion chambers
- Gas pilot included with separate supply line
- Heavy oil electric heating system on board
- Configured and special version on request according to feasibility



CONFIGURATIONS

MULTIFLAM range is available in the following operation modes:

MULTIFLAM	Two stages in gas / two stages in heavy oil	MULTIFLAM 200.1
MULTIFLAM ... PR	Two stage progressive/modulating mechanical in gas and in heavy oil	MULTIFLAM 300.1 PR ... 1800.1 PR
MULTIFLAM ... PRE	Two stage progressive/modulating electronic in gas and in heavy oil	MULTIFLAM 300.1 PRE ... 1800.1 PRE

Other available configurations:

- Continuous ventilation versions
- High temperature versions
- High viscosity versions suitable for 118 cSt (15 °E) at 80 °C available on request

FUEL:

- Natural gas (G20, G25 according to EN676)
- LPG
- Heavy oil (max viscosity 380 cSt (50 °E) at 50 °C)

EMISSIONS

Class	NOx mg/kWh
1	170
2	120
3	80

All models are in compliance with EN 676 European Standard

CONFORM TO

- All products are built in accordance with the following directives:
- 2006/42/EC Machinery Directive
 - 2014/30/UE EMC Directive
 - 2014/35/UE Low Voltage Directive
 - 2009/142/CEE Gas Appliances Directive

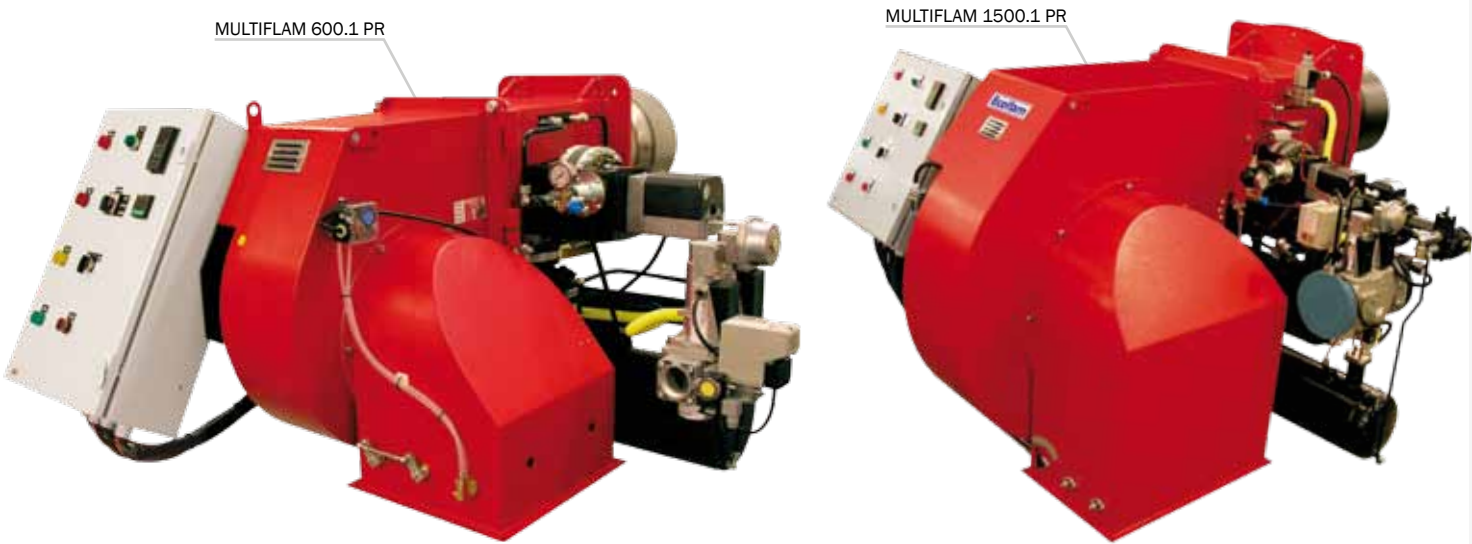

- Fuel: natural gas, LPG; heavy oil (max viscosity 380 cSt (50 °E) at 50 °C)
- Operation: two stages
- Emission class: Low NOx class 2 (≤ 120 mg/kWh) according to EN676 in gas

WORKING DIAGRAM

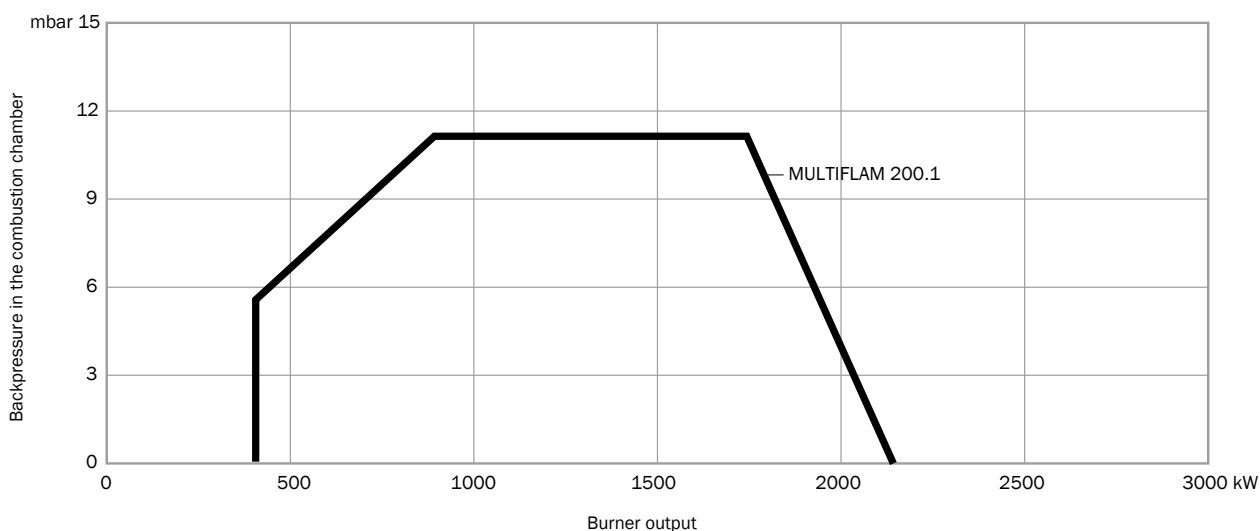

TECHNICAL DATA

	Burner output (kW)	Flow rate (kg/h)	Power supply	Motor (kW)	NOx class (in gas)	Operation
MULTIFLAM 200.1	414 - 2150	36 - 189	3/230-400/50Hz	4	Class 2	PAB

OVERALL DIMENSIONS

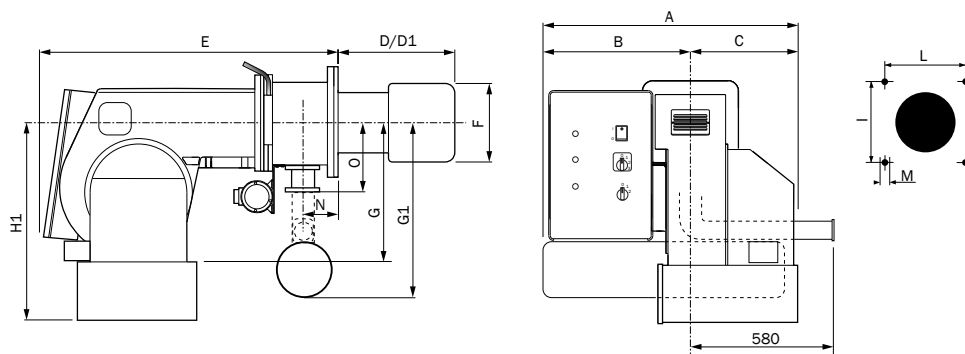

Dimensions in mm
 Head lenght: D short / D1 long
 *: with silencer (optional)

	A	B	C	D	D1	E	F	G	G1	H1*	I	L	M	N	O
MULTIFLAM 200.1	915	335	580	290	490	1150	270	420	600	680	315	315	M16	125	250

Range | Models
MULTIFLAM 300.1 - 400.1 - 500.1 - 600.1

- Fuel: natural gas, LPG; heavy oil (max viscosity 380 cSt (50 °E) at 50 °C)
- Two stage progressive or modulating with the installation of a power regulator and dedicated probes (see page 102)
- Emission class: Low NOx class 2 (≤ 120 mg/kWh) according to EN676 in gas

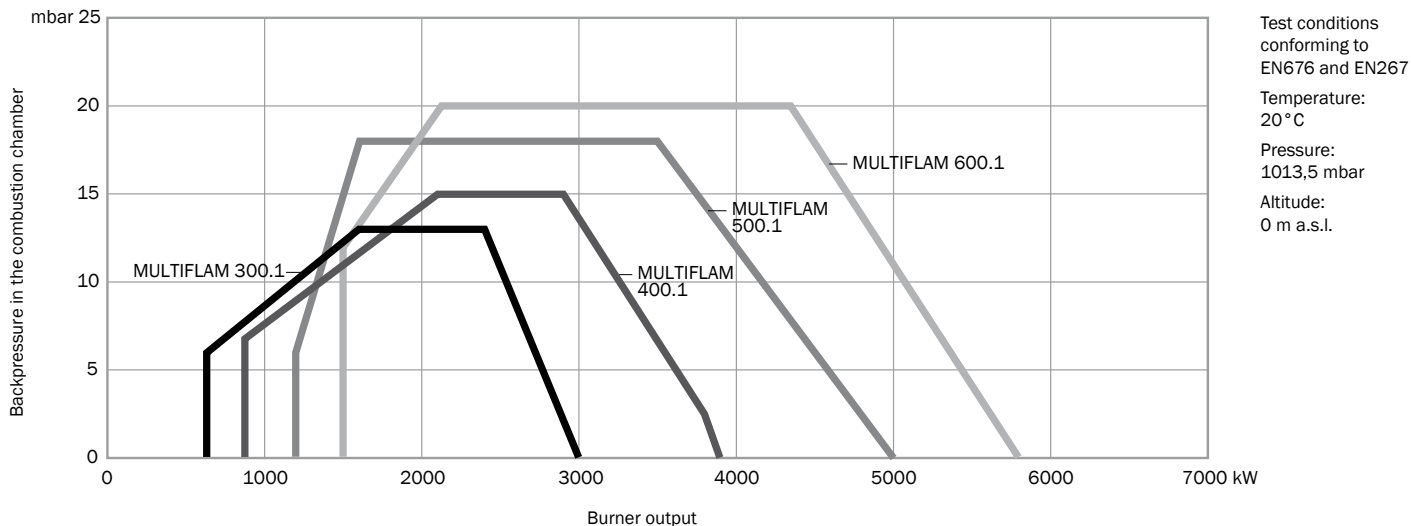

	Output range (kW)	Flow rate (kg/h)	Power supply	Motor (kW)	NOx class (in gas)	Operation
MULTIFLAM 300.1	630 - 3000	55 - 264	3/400/50Hz	5,5	Class 2	PR, PRE
MULTIFLAM 400.1	875 - 3900	77 - 343	3/400/50Hz	7,5	Class 2	PR, PRE
MULTIFLAM 500.1	1200 - 5000	105 - 440	3/400/50Hz	11	Class 2	PR, PRE
MULTIFLAM 600.1	1500 - 5800	132 - 510	3/400/50Hz	15	Class 2	PR, PRE

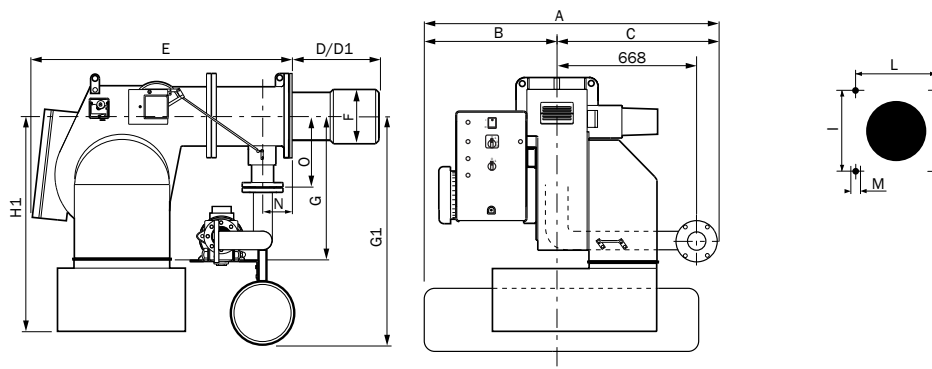

Dimensions in mm
 Head length: **D** short / **D1** long
 *: with silencer (optional)

	A	B	C	D	D1	E	F	G	G1	H1*	I	L	M	N	O
MULTIFLAM 300.1	1288	610	678	330	530	1130	290	471	750	746	315	315	M16	195	250
MULTIFLAM 400.1	1288	610	678	345	545	1130	320	471	750	746	315	315	M16	195	250
MULTIFLAM 500.1	1358	680	678	354	554	1230	320	570	775	965	330	330	M16	195	250
MULTIFLAM 600.1	1358	680	678	354	554	1230	320	570	775	965	330	330	M16	195	250

MULTIFLAM 700.1 - 800.1 - 1000.1 - 1200.1

Range Models

- Fuel: natural gas, LPG; heavy oil (max viscosity 380 cSt (50 °E) at 50 °C)
- Operation: two stage progressive or modulating with the installation of a power regulator and dedicated probes (see page 102)
- Emission class: Low NOx class 2 (≤ 120 mg/kWh) according to EN676 in gas

WORKING DIAGRAM

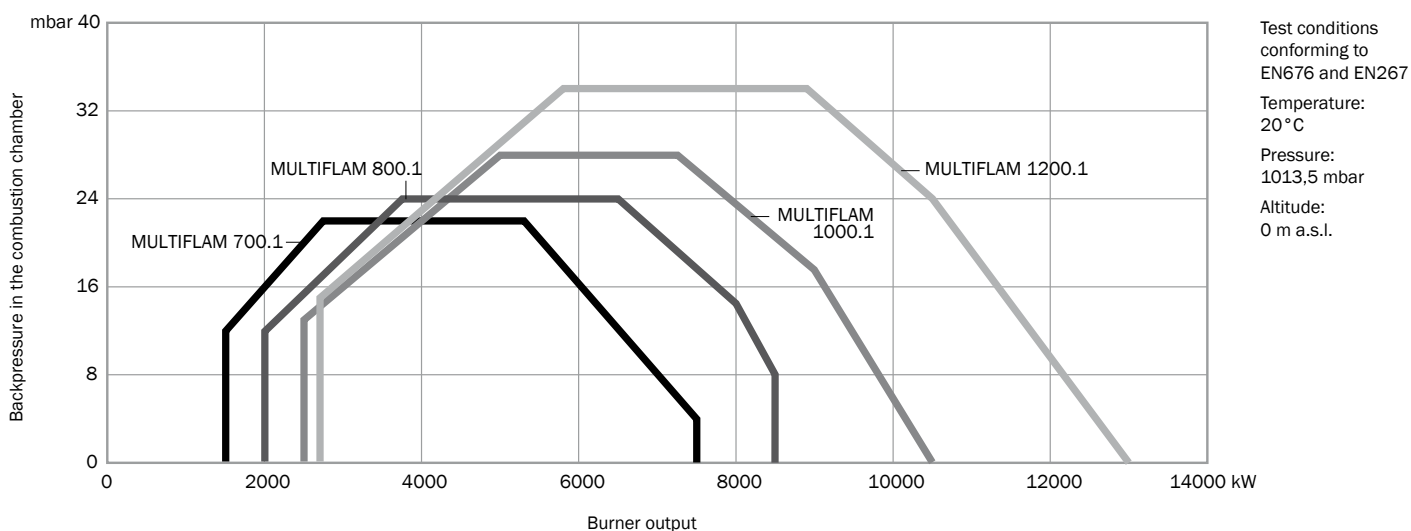

TECHNICAL DATA

	Output range (kW)	Flow rate (kg/h)	Power supply	Motor (kW)	NOx class (in gas)	Operation
MULTIFLAM 700.1	1500 - 7500	132 - 660	3/400/50Hz	15	Class 2	PR, PRE
MULTIFLAM 800.1	2000 - 8500	176 - 748	3/400/50Hz	18,5	Class 2	PR, PRE
MULTIFLAM 1000.1	2500 - 10500	220 - 924	3/400/50Hz	22	Class 2	PR, PRE
MULTIFLAM 1200.1	2700 - 13000	237 - 1143	3/400/50Hz	37	Class 2	PR, PRE

OVERALL DIMENSIONS

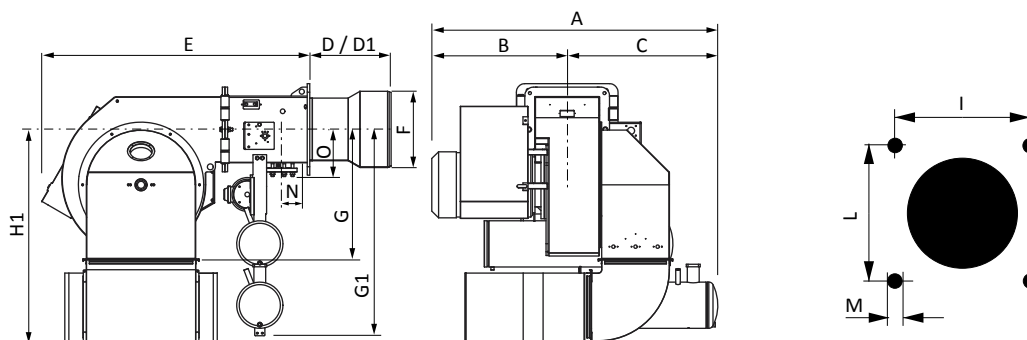

Dimensions in mm
Head length: D short / D1 long
*: with silencer (optional)

	A	B	C	D	D1	E	F	G	G1	H1*	N	O	I	L	M
MULTIFLAM 700.1	1370	740	630	470	-	1640	420	775	850	1270	195	232	460	460	M20
MULTIFLAM 800.1	1370	740	630	470	-	1640	420	775	850	1270	195	232	460	460	M20
MULTIFLAM 1000.1	1500	740	760	470	-	1640	420	775	850	1270	195	232	460	460	M20
MULTIFLAM 1200.1	1700	800	900	470	-	1640	450	775	1200	1270	195	232	460	460	M20

Range | Models
MULTIFLAM 1500.1 - 1800.1

- Fuel: natural gas, LPG; heavy oil (max viscosity 380 cSt (50 °E) at 50 °C)

BURNERS

Two stage progressive or modulating with the installation of a power regulator and dedicated probes (see page 102)

- Emission class: Low NOx class 2 (≤ 120 mg/kWh) according to EN676 in gas

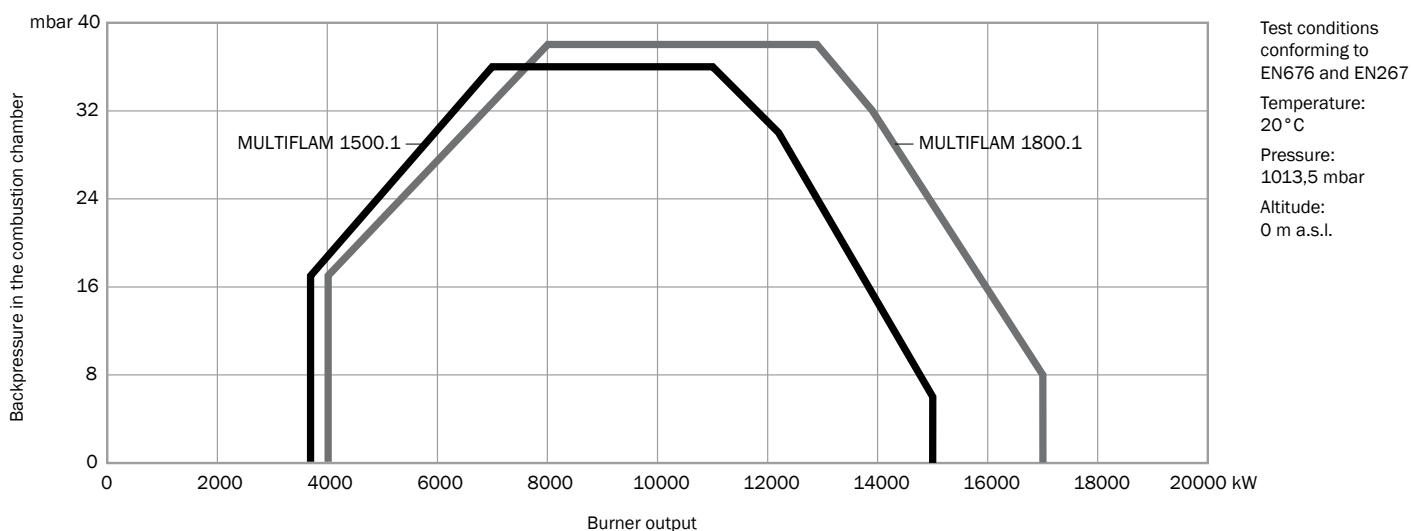

	Output range (kW)	Flow rate (kg/h)	Power supply	Motor (kW)	NOx class (in gas)	Operation
MULTIFLAM 1500.1	3690 - 15000	324 - 1319	3/400/50Hz	45	Class 2	PR, PRE
MULTIFLAM 1800.1	4000 - 17000	352 - 1495	3/400/50Hz	55	Class 2	PR, PRE

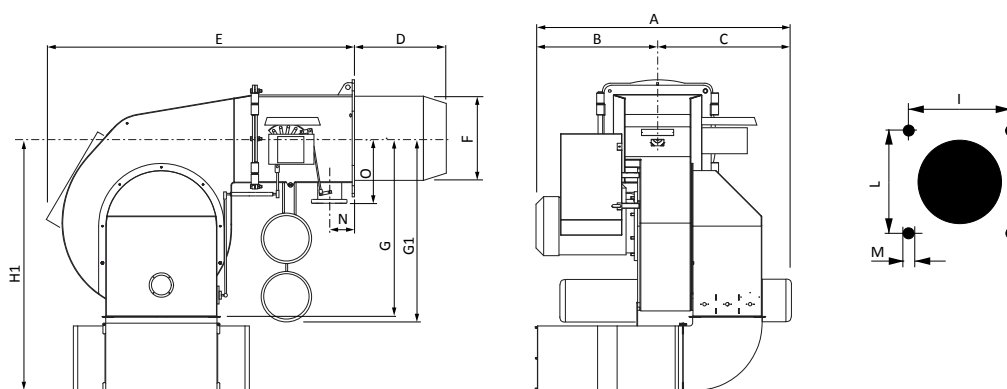

Dimensions in mm
 Head length: D short / D1 long
 *: with silencer (optional)

	A	B	C	D	D1	E	F	G	G1	H1*	N	O	I	L	M
MULTIFLAM 1500.1	1700	800	900	590	-	1910	550	1170	1220	1670	210	320	620	620	M20
MULTIFLAM 1800.1	1770	870	900	590	-	1910	550	1170	1220	1670	210	320	620	620	M20

HEAD OFFICE:
Via Roma, 64
31023 Resana (TV)

REGISTERED OFFICE:
Viale A. Merloni, 45
60044 Fabriano (AN)

Tel.: +39 0423 719500
Fax: +39 0423 719580
Email: export@ecoflam-burners.com

Company subject to the direction and coordination of Ariston Group, Via A. Merloni, 45 - 60044 Fabriano (AN) - Italy

Version 1.2 - 01/02/2022

ECOFLAM Bruciatori S.p.A. reserve the right to make any adjustments, without prior notice, which is considered necessary or useful to its products, without affecting their main features.